

 FUJIPLA

# FUJIPLA HLA

## HLA-2301

### Automatic Laminator



**Adding value to digital finishing**

**Fully automatic laminator that operates like a photo copier.**

## Improves usability and process efficiency

### Achieves automation of lamination work

No film setting for each piece of paper is required.  
Feed, laminate and trim with touch of a button.  
You can operate like a copy machine.

### Automatically detect paper size

From A5 to A3, the paper length in the paper feed direction is automatically detected and trimmed.

### Laminated sheets are uniform and high-quality

Since the four sides of the paper are automatically cut, the margins of the film and the position of the paper are not misaligned, and the paper is evenly finished. Perfectly trimmed and laminated sheets can be made. The high finishing accuracy allows smooth progress to processes such as folding and punching.

### Beginner-Friendly

It's easy to set and switch film with dedicated films.  
No need to switch film to fit paper size.  
It's easy to operate with large-screen panel.  
Using dedicated films with IC Chip is able to automatically detect appropriate mode.

## High-quality and Process Efficiency

### 2 cut modes are available.

Double cut mode that emphasizes the accuracy of the finished size and increases the work efficiency of post-processing.  
Single cut mode that shortening processing time and reducing film loss.

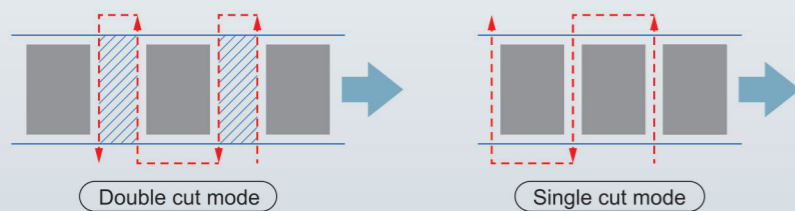

## Reliable Quality and Potential

### Excellent adhesion strength achieved with dedicated films

Even digital printed materials that are difficult to adhere to can be applied.

### Dedicated films with anti-static function make your finished works smooth

Anti-static function help lessen the effects of an electrostatic discharge (ESD) on films.  
Repels dirt and dust during and after processing.

### Performance improved with dedicated film

Dedicated films from 38µm to 125µm are available to serve different purposes.  
You can choose the thickness according to the purpose, such as folding menu.  
Glossy type, matte type and sticky type films are released sequentially now!



## Creation of ideas and added value

### Margin setting

It's possible to set margins of four sides  
You can easily switch between "With Margin", "Without Margin" or "Binding Margin" finishings.



By setting the margins, it is also possible to finish in a deformed size or just the right size.

Use the margin setting to complete surface processing and trimming simultaneously.

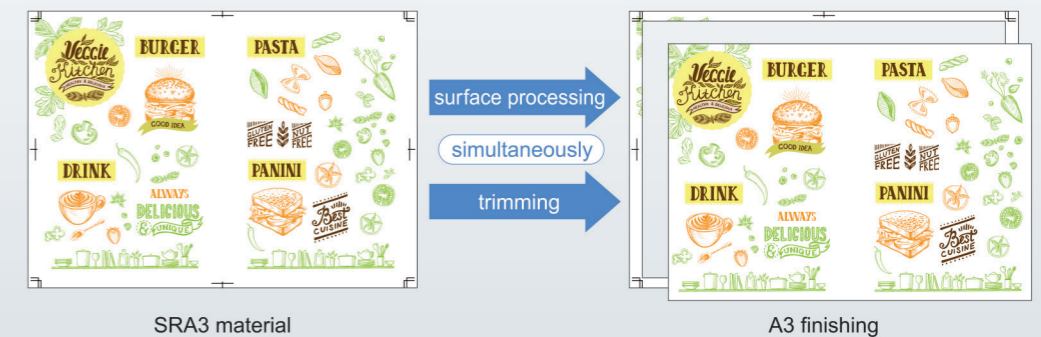

### Connect and process multiple documents

Connect the set number of sheets to create a long laminated sheet.

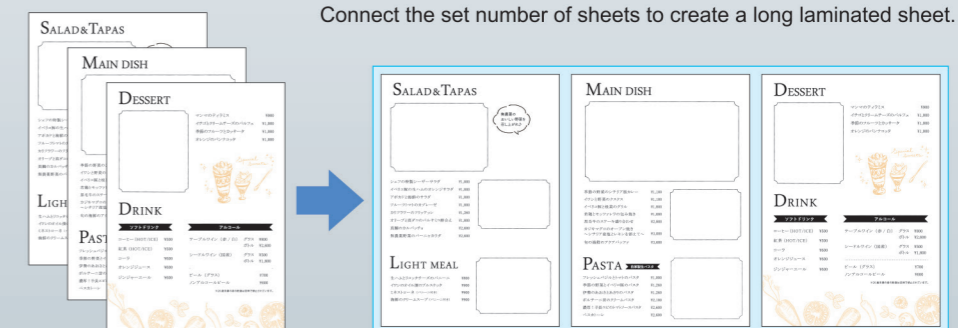

### Also be able to laminate document in any length

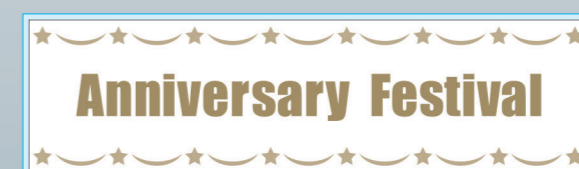

Processing with width of 182mm to 330mm is possible.

## Dedicated films

### 【Glossy Film】

Thickness (μm)	Item number	Item name	Width (mm)	Length (m)	Quantity (roll)	Processible sheets (Approx)	Anti-static function	Remarks
38	HAR382340	HLA-Roll Film Gloss SAP	230	400	2	2,597	◎	Type for digital printed material
75	HAR752320			200		1,298	◎	
38	HAR383240	HLA-Roll Film Gloss SAP	320	400	2	1,851	◎	
75	HAR753220			200		925	◎	
100	HAR103215			150		694	◎	
125	HAR123212			120		547	◎	

### 【Matt Film】

Thickness (μm)	Item number	Item name	Width (mm)	Length (m)	Quantity (roll)	Processible sheets (Approx)	Anti-static function	Remarks
38	HARM383240	HLA-Roll Film Matt SAP	320	400	2	1,851	◎	Type for digital printed material
75	HARM753220			200		925	◎	
125	HARM123212			120		547	◎	
30	HARSM30324	HLA-Roll Film SilkyMatt ECO	320	400	2	1,851		Type for offset printed material
75	HARSM75322			200		925		
125	HARSM12321			120		547		

### 【Single side Film】

Thickness (μm)	Item number	Item name	Width (mm)	Length (m)	Quantity (roll)	Processible sheets (Approx)	Anti-static function	Remarks
30	HARN303240	HLA-ROLL Single side NylonFilm Gloss SAP	320	400	2	1,851	◎	Single side film Type for digital printed material Nylon Film/Underfilm
30	HARNM30324	HLA-ROLL Single side NylonFilm Matt SAP	320	400	2	1,851	◎	
25	HARU253240	HLA-ROLL UnderFilm	320	400	2	1,851	◎	

### 【Sticky Film】

Thickness (μm)	Item number	Item name	Width (mm)	Length (m)	Quantity (roll)	Processible sheets (Approx)	Anti-static function	Remarks
100	HART1010R	HLA-Roll Film Sticker Gloss ECO	320	100	2	462	◎	Type for offset printed material Repeelable type

Processible sheets calculation : 320mm width is measured with A4, 230mm width is measured with A5 by Single cut mode

## Specifications

Item number	HLA-2301
Laminating speed	0.5~2.1m/min *1
Warm-up time	Approximately 6minutes 30seconds *2
Temperature range	80~130°C
Maximum load	200 sheets (64g/m <sup>2</sup> copying paper)
Maximum thickness	500μm (Including film)
Supported films	HLA dedicated films (38μm · 75μm · 100μm · 125μm)
Supported paper thickness	70~250μm · 64~209g/m <sup>2</sup>
Supported paper	Copy paper, Coated paper, Matte paper, Art paper (something excluded)
Supported paper size	A5 · A4 · A3
Maximum paper size	330(W)×500(L)mm *3
Minimum paper size	182(W)×148(L)mm
Margin	Cutting position adjustment (Front : -30mm~+25mm Back : -25mm~+30mm) *4
Trimming	Slitter position adjustment (Inside : 3mm Outside : 3mm) *4
Power-supply voltage	AC100 ~ 240V (50/60Hz)
Power consumption	1200W
Body size	912(W)×590(D)×1149(H)mm (Assembled) 1327(W)×590(D)×1149(H)mm (Maximum Assembled size with extension tray)
Body weight	77kg (Assembled) (Body : 52kg, Stand : 25kg)
Accessories	Feeder Tray, Extension Tray, Rear Tray, Power Cord, Instruction Manual, Waste Collection Box, Stand

Note : Corners are cut square.

\*1 Speed may differ according to paper and films. \*2 Warm-up time may differ according to the environment.

\*3 Long Mode is exceptional. If you add margins to the film, the maximum width of the paper is 297mm. \*4 Margin and Trimming is accurate to within ±0.5mm.

Please note that the above information is subject to change without notice. Product names and company names displayed are the registered trademarks of their respective companies. Imitation of listed products may be subject to claims for damages and injunctions. The content of this catalogue are as of February 2023.

Shop online at [www.duplo-supplies.co.uk](http://www.duplo-supplies.co.uk) for all your Finishing Supplies, Consumables and hardware.

Tel 01932 263966  
Email [ecom@duplointernational.co.uk](mailto:ecom@duplointernational.co.uk)

Duplo International Ltd  
Automated Precision House, Hamm Moor Lane, Addlestone, Surrey. KT15 2SD

**Duplo**  
Supplies